

User Manual

HD-70X

HDMI Twisted Pair PoC Extender over Single Twisted Pair



All Rights Reserved

Version: HD-70X_2016V1.0

SAFETY PRECAUTIONS

To insure the best from the product, please read all instructions carefully before using the device. Save this manual for further reference.

- Unpack the equipment carefully and save the original box and packing material for possible future shipment
- Follow basic safety precautions to reduce the risk of fire, electrical shock and injury to persons.
- Do not dismantle the housing or modify the module. It may result in electrical shock or burn.
- Using supplies or parts not meeting the products' specifications may cause damage, deterioration or malfunction.
- Refer all servicing to qualified service personnel.
- To prevent fire or shock hazard, do not expose the unit to rain, moisture or install this product near water.
- Do not put any heavy items on the extension cable in case of extrusion.
- Do not remove the housing of the device as opening or removing housing may expose you to dangerous voltage or other hazards.
- Install the device in a place with fine ventilation to avoid damage caused by overheat.
- Keep the module away from liquids.
- Spillage into the housing may result in fire, electrical shock, or equipment damage. If an object or liquid falls or spills on to the housing, unplug the module immediately.
- Do not twist or pull by force ends of the optical cable. It can cause malfunction.
- Do not use liquid or aerosol cleaners to clean this unit. Always unplug the power to the device before cleaning.
- Unplug the power cord when left unused for a long period of time.

NOTICE: Please read this user manual carefully before using this product. Pictures shown on this manual are for reference only, different model and specifications are subject to real product.

This manual is for operation instruction only, not for any maintenance usage. The functions described in this version are updated till June 2016. Any changes of functions and parameters since then will be informed separately. Please refer to the dealers for the latest details.

All rights reserved. No part of this publication may be copied or reproduced without prior written consent.

All product function is valid till 2016-06-30.

Update History

Version	Date	Update includedt
1.0	2016.06.30	First Version

Table of Contents

1. Introduction	1
1.1 Introduction to HDMI Twisted Pair PoC Extender HD-70X	1
1.2 Features	1
1.3 Package Contents	1
2. Introduction of Product Appearance HD-70X	2
2.1 Appearance of HDMI Twisted Pair PoC Transmitter HD-70XT	2
2.2 Appearance of HDMI Twisted Pair PoC Receiver HD-70XR.....	3
3. System Connection.....	4
3.1 Usage Precautions	4
3.2 System Diagram	4
3.3 Connection Procedure	4
3.4 Application	5
3.5 Twisted Pair Cable Connection.....	5
3.6 Collocation Products.....	6
4. Specification	8
5. Panel Drawing	9
6. Troubleshooting & Maintenance	10
7. After-sales Service	11

1. Introduction

1.1 Introduction to HDMI Twisted Pair PoC Extender HD-70X

HDMI Twisted Pair PoC Extender HD-70X is an HDMI/IR/RS232 twisted pair including transmitter (HD-70XT) and receiver (HD-70XR). The HDMI Twisted Pair PoC Extender uses HDBaseT technology to deliver HDMI signal, max transmission distance up to 70 meters with CAT5e/CAT6 cable. CEC, bi-directional RS232&IR control, and PoC are supported by HDMI Twisted Pair PoC Extender.

1.2 Features

- Support Full HD: Delivers resolutions including 800x600@60Hz, 1024x768@Hz, 1280x720@60Hz, 1280x1024@60Hz, 1366x768@60Hz, 1600x1200@60Hz, 1920x1080@60Hz, 1920x1200@60Hz, 3D, 4K×2K
- Max transmission distance is up to 70 meters over single CAT5e/CAT6 cable.
- High Bandwidth: 10.2Gps.
- HDTV Compatible, use HDMI 1.4 and HDCP compliant.
- Support POC & CEC.
- Connect with a displayer to transmit EDID and HPD signals constantly by using a CAT5e cable.
- Use HDBaseT technology.
- Bi-directional RS232/IR control.
- LED indicators show work status.
- Wall/table-mountable aluminium enclosure, PT case design.

Note: Please use a CAT5e cable with low impedance (Shielded twisted pair will be better and should be well grounded) for good transmission effect.

1.3 Package Contents

- 1 x HD-70XT: HDMI Twisted Pair PoC Transmitter
- 1 x HD-70XR: HDMI Twisted Pair PoC Receiver
- 4 x Mounting brackets (Separated from HDMI Twisted Pair PoC Extender)
- 8 x Plastic cushions
- 1 x RS232 cables
- 8 x Screws
- 1 x Power adapters (DC 24V)
- 1 x User manual

Notes: Please confirm if the product and the accessories are all included, if not, please contact with the dealers.

2. Introduction of Product Appearance HD-70X

2.1 Appearance of HDMI Twisted Pair PoC Transmitter (HD-70XT)

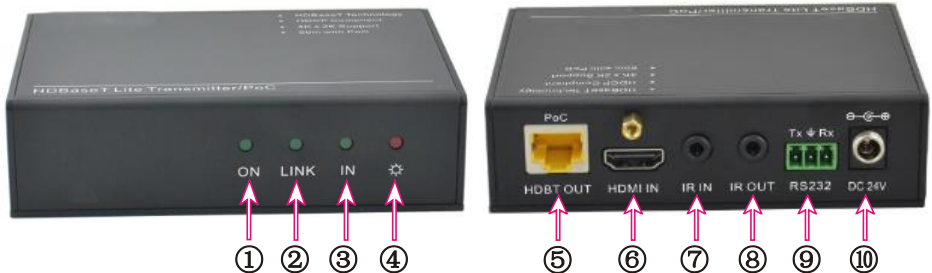

Figure 2-1 Appearances of HDMI Twisted Pair PoC Transmitter HD-70XT

- 1) ON: Working status indicator of this device. When the device works fine, this green LED will keep blinking. And it will get off when the device stops work.
- 2) LINK: Twisted Pair Link status indicator, green LED. It will keep on when connection is successful.
- 3) IN: When connected with devices support HDCP and work normally this LED will keep on. If devices not support HDCP, this green LED will blink.
- 4) POWER LED: LED indicator of power. When connect with power, red LED will keep on.
- 5) HDBT OUT: Connect to the HDBT IN port of HDMI Twisted Pair PoC Receiver with a CAT5e cable.
- 6) HDMI IN: Connect to HDMI source.
- 7) IR IN: Connect with IR receiver, the IR signal received from this port can only send out in HDMI Twisted Pair PoC Receiver.
- 8) IR OUT: Connect with IR sender, the sending IR signal are received from HDMI Twisted Pair PoC Receiver.
- 9) RS232: RS232 connector.
- 10) DC 24V: Connect with power supply (Not necessary if HDMI Twisted Pair PoC Receiver connects with power).

Note: Pictures shown on this manual are for reference only, different model and specifications are subject to real product.

2.2 Appearance of HDMI Twisted Pair PoC Receiver (HD-70XR)

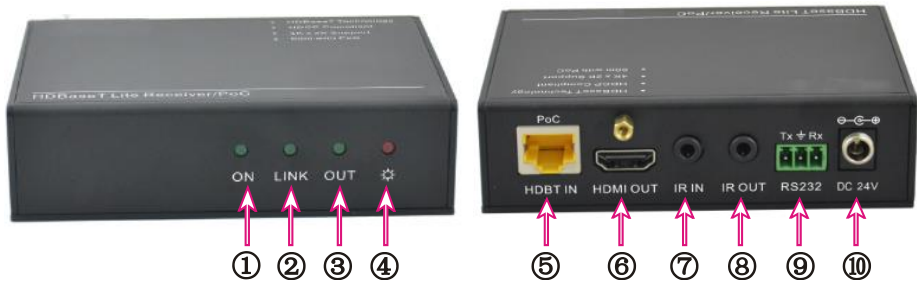

Figure 2-2 Appearances of HDMI Twisted Pair PoC Receiver HD-70XR

- 1) ON: Working status indicator of this device. When the device works fine, this green LED will keep blinking. And it will get off when the device stops work.
- 2) LINK: Twisted Pair Link status indicator, green LED. It will keep on when connection is successful.
- 3) OUT: When connected with devices support HDCP and work normally this LED will keep on. If devices not support HDCP, this green LED will blink.
- 4) POWER LED: When connect with power, red LED will keep on.
- 5) HDBT IN: Connect to the HDBT OUT port of HDMI Twisted Pair PoC Transmitter with a CAT5e cable.
- 6) HDMI IN: Connect to HDMI display device.
- 7) IR IN: Connect with IR receiver, the IR signal received from this port can only send out in HDMI Twisted Pair PoC Transmitter.
- 8) IR OUT: Connect with IR emitter, the sending IR signal are received from HDMI Twisted Pair PoC Transmitter.
- 9) RS232: RS232 connector.
- 10) DC 24V: Connect with power supply (Not necessary if HDMI Twisted Pair PoC Transmitter connects with power).

Note: Pictures shown on this manual are for reference only, different model and specifications are subject to real product.

3. System Connection

3.1 Usage Precautions

- 1) System should be installed in a clean environment and has a prop temperature and humidity.
- 2) All of the power switches, plugs, sockets and power cords should be insulated and safety.
- 3) All devices should be connected before power on.

3.2 System Diagram

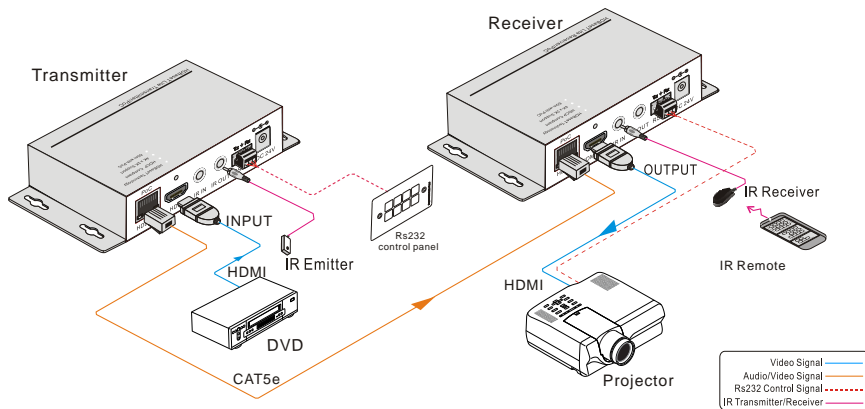

Figure 3-2 System Connection Diagram

3.3 Connection Procedure

- Step1.** Connect HDMI source (such as Blue-ray DVD) to **HDMI IN** port of transmitter HD-70XT (HDMI Twisted Pair PoC Transmitter) with HDMI cable.
- Step2.** Connect **HDBT OUT** port of transmitter HD-70XT and **HDBT IN** port of receiver HD-70XR, with single CAT5e/CAT6 cable.
- Step3.** Connect HDMI display (such as HDTV) to **HDMI OUT** port of receiver HD-70XR with HDMI cable.
- Step4.** Both HDMI Twisted Pair PoC Transmitter and HDMI Twisted Pair PoC Receiver have IR IN and OUT. When one end is used as an IR receiver, the signal sent from the end can only be transmitted via the other end.
For example: When "IR IN" of HD-70XT connects with an IR receiver, the IR transmitter must connect to IR OUT of HD-70XR.

HDMI/IR/RS232 Twisted Pair PoC Extender

Step5. Connect the RS232 port of the devices to be controlled and the receiver HD-70XR or the transmitter HD-70XT.

Step6. Connect with DC24V power adaptor(s) (One is enough if any end of HDMI Twisted Pair PoC Transmitter and HDMI Twisted Pair PoC Receiver is connected with adapter as its PoC function).

3.4 Application

HDMI Twisted Pair PoC Extender HD-70X has a good application in various occasions, such as computer realm, monitoring, big screen displaying, meeting room, education and bank & securities institution etc.

3.5 Twisted Pair Cable Connection

The twisted pair used in this extender **MUST** be a straight-through cable.

TIA/EIA T568A		TIA/EIA T568B	
Pin	Cable color	Pin	Cable color
1	green white	1	orange white
2	green	2	orange
3	orange white	3	green white
4	blue	4	blue
5	blue white	5	blue white
6	orange	6	green
7	brown white	7	brown white
8	brown	8	brown
1st Ground	4--5	1st Ground	4--5
2nd Ground	3--6	2nd Ground	1--2
3rd Group	1--2	3rd Group	3--6
4th Group	7--8	4th Group	7--8

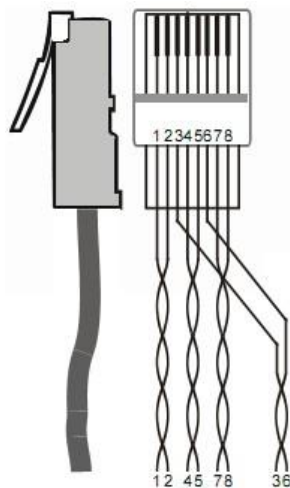

Notice: Cable connectors **MUST** be metal one, the shielded layer of cable **MUST** be connected to the connector's metal shell, to make a better transmission.

3.6 Collocation Products

HDMI Twisted Pair PoC Extender HD-70X usually work together with other devices to extend the transmission distance of HDMI/IR/RS232 signal. Here are the most common collocation products.

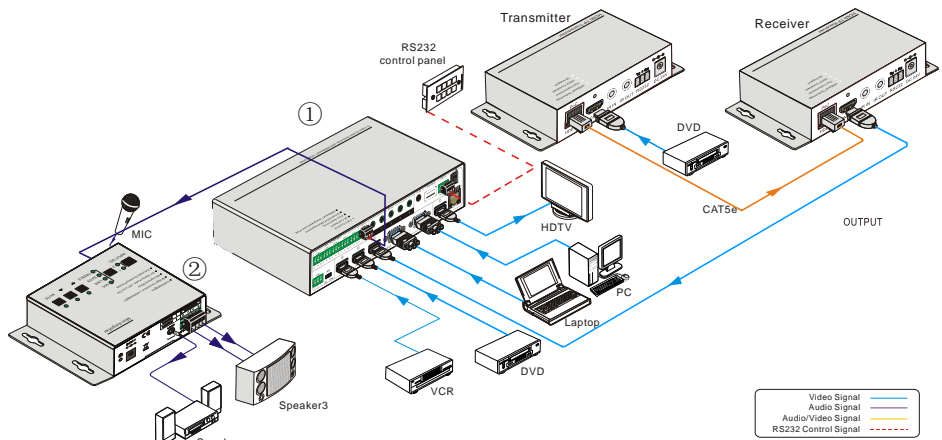

Figure 3-2 Collocation Products Connection Diagram

Description:

1) Full HD Scaler Switcher HD-51D

- 5 video Inputs: 3 x HDMI & 2 x VGA and upscale to HDMI output at 1080P. VGA video supports C-video, YPbPr and VGA
- Support VGA resolutions: 640x480, 800x600, 1024x768, 1280x1024, 1280x768, 1280x720, 1360x768@60Hz, 1600x1200, 1920x1080 (1080p). 1920x1200..
- Built-in PAL/NTSC and audio format automatic identification technologies, with good video and audio processing technology for high performance.
- Audio selection: Embedded HDMI Audio or external
- 48V phantom power to support condenser microphone.
- 6 audio Inputs: 3 x Dual-Mono Stereo Audio for HDMI, 2 x Dual-Mono Stereo Audio for VGA, 1 x microphone audio (all 3-pin captive screw connector)
- 1 audio output: 1 x Stereo Audio Out (3-pin captive screw connector) ; 50KΩ
- Supports CEC, with commands to enable/disable this function
- Compliant with HDCP
- Controllable via button, IR & RS232

2) Mini digital amplifier AMV2B

- 2x20Watt@4Ω as the default amplifier output.
- Bridge connection function. User can switch the amplifier to be 1x40Watt@8Ω by bridge connection.
- 48V phantom power to support condenser microphone.
- MIC port can support balance/unbalance signal, suppress the external noise effectively.

4. Specification

Model	HDMI Twisted Pair PoC Transmitter (HD-70XT)	HDMI Twisted Pair PoC Receiver (HD-70XR)
Spec		
Input		
Input Signal	1 HDMI, 1 IR & 1 RS232	1 IR, 1 HDBaseT & 1 RS232
Input Connector	HDMI female, 3.5mm mini jack, 3-pin captive screw connector	RJ-45, 3.5mm mini jack, 3-pin captive screw connector
Video Signal	HDMI1.4	HDMI1.4
Audio	Digital audio, transmit through HDMI audio	Digital audio, transmit through HDMI audio
Output		
Output	1 HDBaseT, 1 IR, 1 RS232	1 HDMI, 1 IR, 1RS232
Output Connector	RJ-45, 3.5mm mini jack, 3-pin captive screw connector	HDMI female, 3.5mm mini jack, 3-pin captive screw connector
Video signal	HDMI1.4	HDMI1.4
Transmission Mode	HD Base T	
General		
Resolution	800x600 ~ 1920x1200, 3D, 4K x 2K (UHD) 800x600@60Hz, 1024x768@Hz, 1280x720@60Hz, 1280x1024@60Hz, 1366x768@60Hz, 1600x1200@60Hz, 1920x1080@60Hz, 1920x1200@60Hz, 3D, 4K × 2K	
Transmission Distance	Max distance 70M	
SNR	>70dB@ 100MHz-100M	
Bandwidth	10.2Gbps	
THD	<0.005%@1KHz	
HDMI Standard	Support HDMI1.4, 3D and HDCP	
Impedance	75Ω	
Temperature	-10 ~ +40℃	
Humidity	10% ~ 90%	
Power Supply	Input: 100VAC~240VAC, 50/60Hz Output: DC 24V, 1.25A	
Power Consumption	9.6W	
Case Dimension	W110xH28x D77 mm	W110xH28x D77 mm
Net Weight	0.5Kg	0.5Kg

NOTE: All nominal levels are at ±10%.

5. Panel Drawing

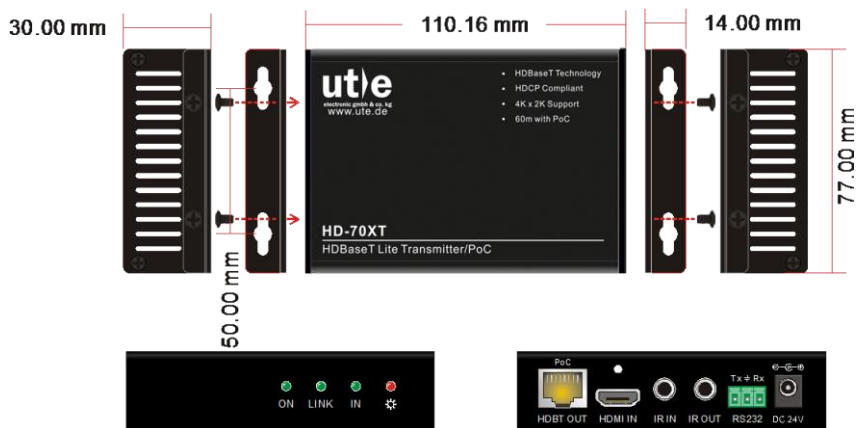

Figure 5-1 Panel drawing of HDMI Twisted Pair PoC Transmitter HD-70XT



Figure 5-1 Panel drawing of HDMI Twisted Pair PoC Receiver HD-70XR

6. Troubleshooting & Maintenance

Problems	Causes	Solutions
Output images in display show with ghost	Incorrect setting on the display	Check the display's setting
	A cable of bad quality	Try another high quality connection cable
No output image when switching	No signal at the input / output end	Check with oscilloscope or multimeter if there is any signal at the input / output end.
	Fail or loose connection	Make sure the connection is good
	The extender is broken	Send it to authorized dealer for repairing.
Cannot control the device by control device (e.g. a PC) through RS232 port	Wrong RS232 communication parameters	Make sure the RS232 communication parameters are correct.
	The device has already been broken	Send it to authorized dealer for repairing.
Static becomes stronger when connecting the video connectors	Bad grounding	Check the grounding and make sure it is connected well.
Cannot control the device by RS232 / IR	The device has already been broken	Send it to authorized dealer for repairing.

If your problem persists after following the above troubleshooting steps, seek further help from authorized dealer or our technical support.

7. After-sales Service

If there appear some problems when running the device, please check and deal with the problems reference to this user manual. Any transport costs are borne by the users during the warranty.

1) Product Limited Warranty: It is warranted that the product will be free from defects in materials and workmanship for **three years**, which starts from the first day you buy this product (The purchase invoice shall prevail).

Proof of purchase in the form of a bill of sale or receipted invoice which is evidence that the unit is within the Warranty period must be presented to obtain warranty service.

2) What the warranty does not cover:

- Warranty expiration.
- Factory applied serial number has been altered or removed from the product.
- Damage, deterioration or malfunction caused by:
 - Normal wear and tear
 - Use of supplies or parts not meeting our specifications
 - No certificate or invoice as the proof of warranty.
 - The product model showed on the warranty card does not match with the model of the product for repairing or had been altered.
 - Damage caused by force majeure.
 - Servicing not authorized
 - Any other causes which does not relate to a product defect
- Delivery, installation or labor charges for installation or setup of the product

3) Technical Support: Email to our after-sales department or make a call, please inform us the following information about your cases.

- Product version and name.
- Detailed failure situations.
- The formation of the cases.

Remarks: For any questions or problems, please try to get help from your local distributor or send an E-Mail to U.T.E.: info@ute.de. .



U.T.E. electronic GmbH & Co. KG

Tel: +49-2302-282830

Fax: +49-2302-28283-10

Email: info@ute.de

Website: www.ute.de